A classic sailing yacht, LAMADINE, is shown sailing on the sea. The yacht is a three-masted vessel with white sails, and the background is a clear blue sky and calm water. The text is overlaid on the image in a white, sans-serif font.

Built in 1967 by the renowned British shipyard Camper & Nicholsons, LAMADINE is a distinguished classic sailing yacht that embodies the elegance and craftsmanship of a golden era of yacht building. Measuring 29.57 metres (97 feet) in length, she combines timeless design, exceptional seaworthiness, and refined comfort, making her one of the most admired classic yachts cruising the Mediterranean today. Designed by the legendary naval architect Laurent Giles, who was responsible for her exterior styling, naval architecture, and interior layout, LAMADINE represents a rare example of a yacht conceived entirely under the vision of one of the twentieth century's most respected yacht designers. Her graceful lines, balanced proportions, and enduring aesthetic have allowed her to remain relevant and admired for nearly six decades.

Constructed with a traditional cedar and mahogany hull, an aluminium superstructure, and beautifully finished teak decks, LAMADINE showcases the quality and attention to detail for which Camper & Nicholsons became world famous. Extensive refits and meticulous maintenance over the years have preserved her classic character while incorporating modern systems and amenities expected by contemporary guests.

The yacht features a cold-molded laminated wooden hull constructed from four layers of mahogany and cedar bonded together and fastened with bronze screws and rivets. At the time of its construction in 1967, this was considered an advanced building technique, offering exceptional structural rigidity while keeping weight lower than that of traditional carvel-planked wooden hulls. The hull is supported by a mahogany framework reinforced with multiple longitudinal stringers, a structural arrangement that distributes loads efficiently throughout the vessel and enhances overall strength and durability. Lightweight aluminum alloys were incorporated into key components such as the mast girders, engine beds, and other structural elements, reducing overall displacement without sacrificing strength or integrity. Complementing these construction features is a slender hull form, measuring approximately 29.6 meters in length with a beam of 5.3 meters, reflecting the design philosophy of Laurent Giles, whose yachts were renowned for their seaworthiness, efficient sailing performance, and smooth motion through waves. LAMADINE is for anyone who dreams of starring in classic yacht regattas.

Powered by twin Caterpillar diesel engines, she cruises comfortably at 12 knots and reaches a maximum speed of 14 knots, offering a cruising range of approximately 2,000 nautical miles. Her performance and stability make her ideally suited for extended voyages throughout the Greek islands, the Eastern Mediterranean, and beyond.

LAMADINE accommodates up to six guests in three elegantly appointed staterooms and is attended by a professional crew of four, ensuring a highly personalised charter experience. Her warm interior atmosphere, classic wood finishes, and spacious deck areas create an inviting environment that reflects the charm of traditional yachting while delivering modern comfort.

Flying the Greek flag, LAMADINE has become a familiar and respected presence in the Mediterranean charter market. Today she stands as a remarkable example of classic yacht heritage, offering guests the opportunity to experience authentic sailing aboard a vessel that combines history, craftsmanship, and timeless sophistication.

S/Y LAMADINE



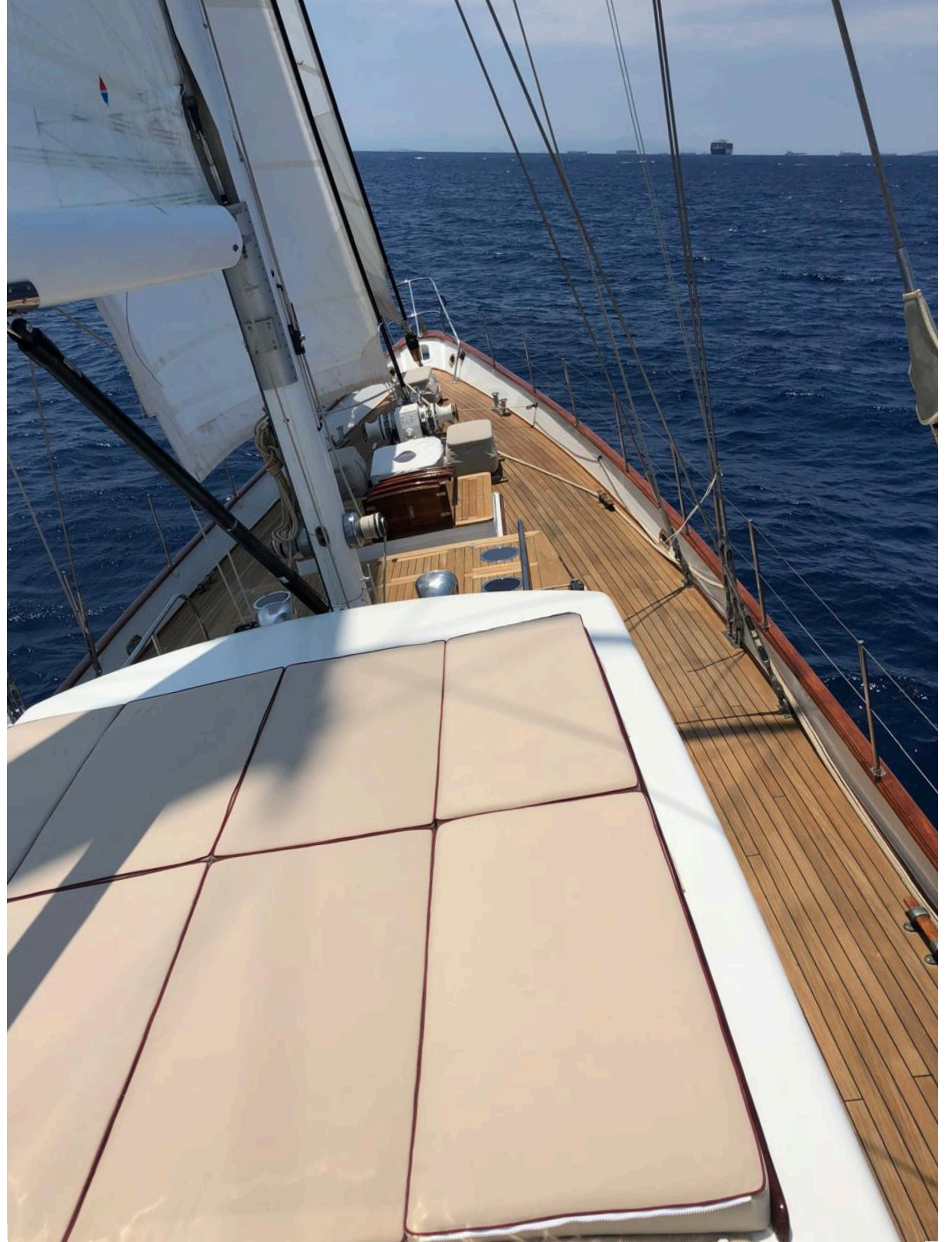



Pamootne

















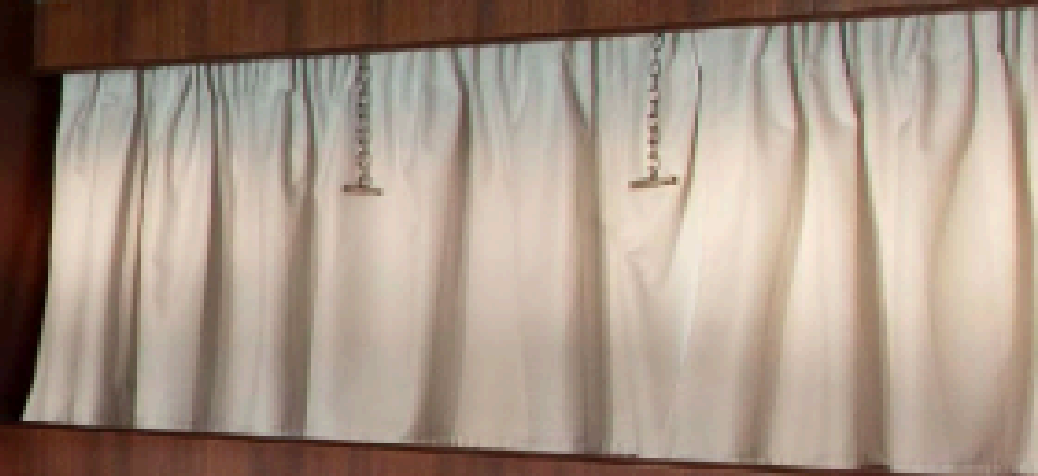















SPECIFICATIONS

CONSTRUCTION: Mahogany Hull, Aluminium Superstructure with teak deck
WATER CAPACITY: 2,500 litres (660.43 US Gallons)
FUEL CAPACITY: 5,000 litres (1,320.86 US Gallons)
CRUISING SPEED: 12 kn
MAXIMUM SPEED: 14 kn

ACCOMMODATION

TOTAL CABINS: 3 | Guests 6
2 x Double Cabins en-suite
1 x Twin Cabin en-suite
CREW CABINS: 3 | Crew Members 4
PEOPLE: 25



MECHANICAL EQUIPMENT

- Generators: 2 x Onan – 24 kW each
- Generator Hours (Port): TBC – Oct 2022
- Generator Hours (Starboard): TBC – Oct 2022

ELECTRICAL

- 220 V single phase, 60 Hz
- Shore power connection: 220 V / 80 A

HVAC

- Marine Air Systems air conditioning
- 2 x 16,000 BTU units
- 2 x 7,000 BTU units
- 1 x 12,000 BTU unit

BATTERIES

- Service batteries: 8 x 220 Ah – 12 V (24 V DC system)
- Battery charger: 1 x Victron Energy Skylla TG24/100 + 1 x RI-MET SA type 24/100 (100 A)
- Inverters: 1 x Paco 1200W, 1 x Paco 2000W, 1 x Paco 600W, 2 x Waeco Perfect Power PP2000W

ENTERTAINMENT

- TV system
- Stereo system (CD / DVD / Radio)
- Amplifier & mixer
- Wi-Fi connectivity
- Power bank
- Library

COMMUNICATION

- VHF

TENDER & WATER TOYS

- Tender

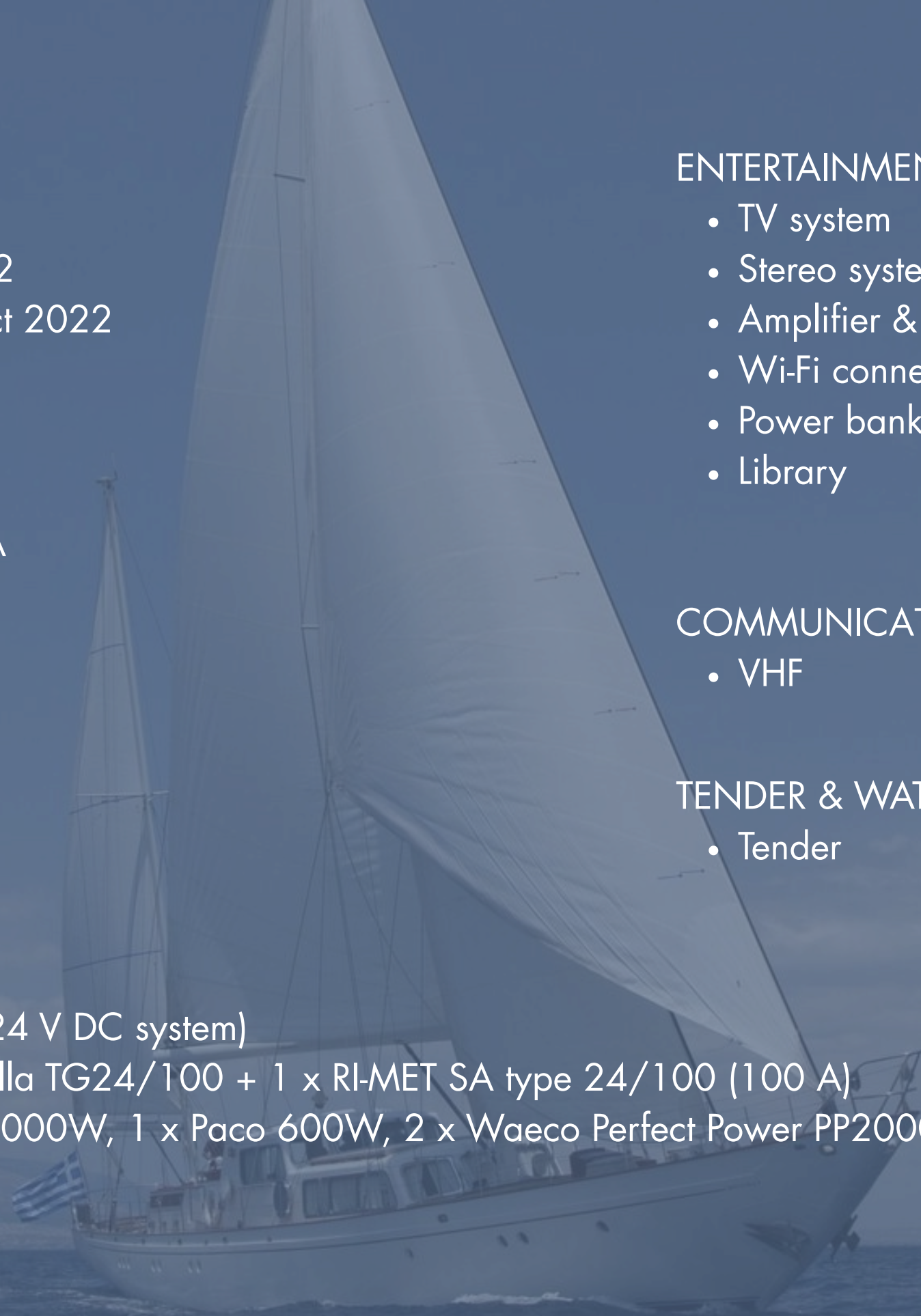

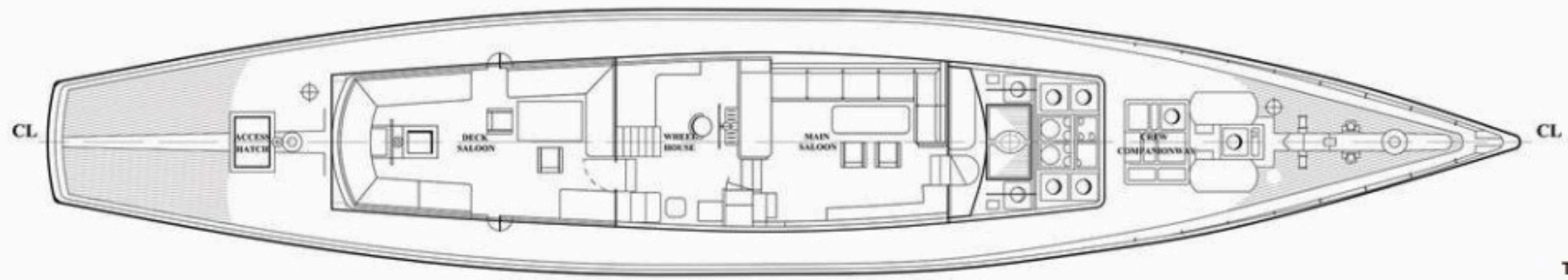
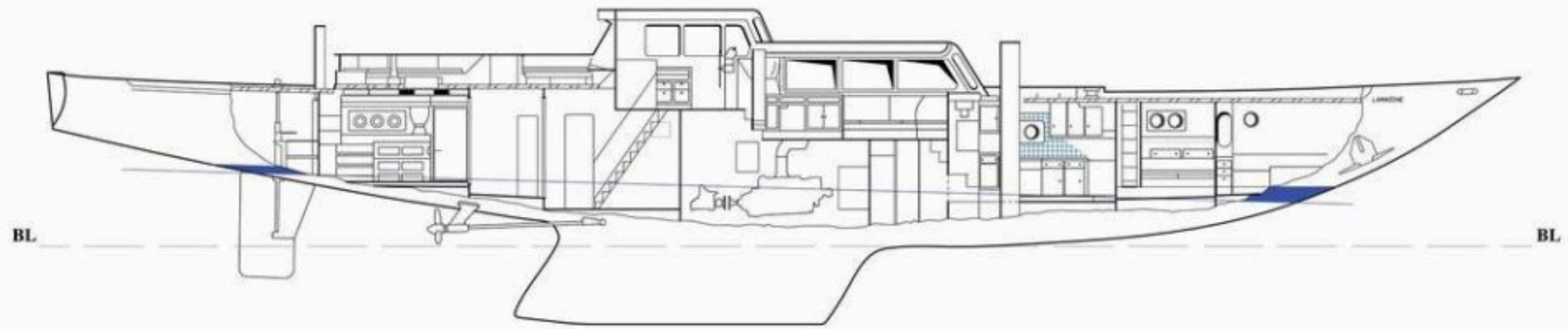

TOP DECK

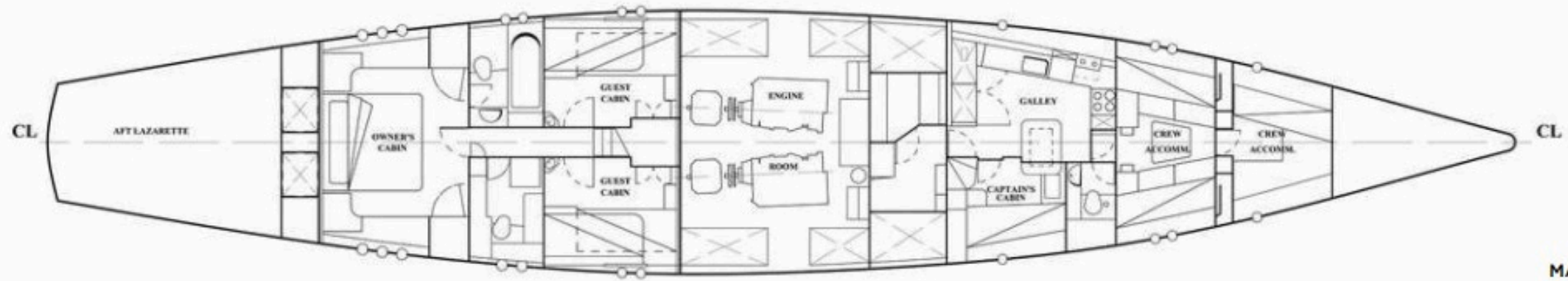

MAIN DECK

**Built by Camper & Nicholsons
(designed by Laurent Giles)**

BUILDER: Camper & Nicholsons
YEAR: 1967
REFIT: 2022
L.O.A: 29.6m
DRAFT: 2.83m
BEAM: 5.31m
ENGINES: 2x Caterpillar C7 254 hp
FLAG: Greek



Nicolas Ertzos
Yacht Broker

nicolas.ertsos@atalantamarine.com

+30 6959 99 5795

ASKING PRICE
€1.190.000 VAT paid